

**Morsetto di sospensione**

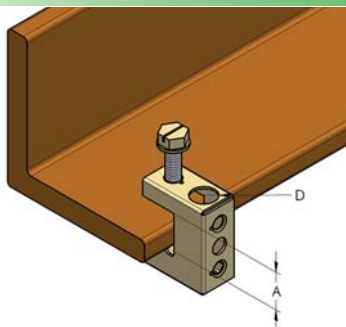

Buckle  
Borne  
Klemme  
Cárcel

D mm	A mm	Codice N°	P g	n°	
10	18	294 010 018	25	20	

**Dado esagonale**

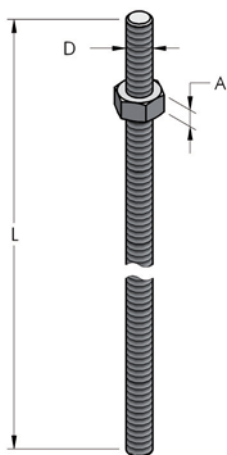

Exagonal nut  
Ecrou hexagonal  
Sechskantmutter  
Tuerca

D mm	A mm	Codice N°	P g	n°	
M6	5	230 006 005	2,5	20	

**Tirante di sospensione**

Hanging tie rod  
Tirant de suspension  
Gewindestange  
Tirante de suspension

D mm	L m	Codice N°	P g	n°	
M6	1	226 006 100	200	10	

**Staffa di sospensione**

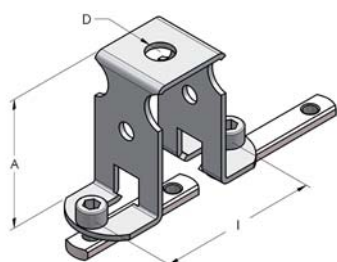

Support "L" plate  
Equerre de supportage  
Befestigungswinkel  
Esquadra de soporte

A mm	l mm	d mm	Codice N°	P g	n°	
50	36-60	6,5	003 001 074	100	10	

**Squadra di supporto**

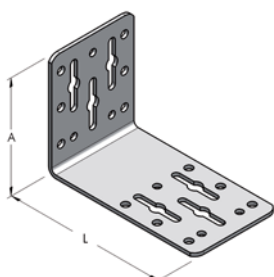

Support "L" plate  
Equerre de supportage  
Befestigungswinkel  
Esquadra de soporte

A mm	L mm	Codice N°	P g	n°	
94	140	732 078 140	420	20	

### Arresto di fine corsa

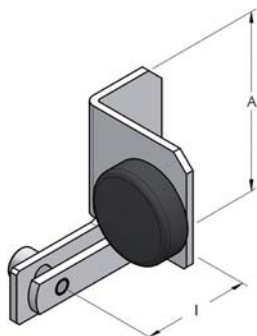

Stroke end stop  
 Fin de course  
 Endanschlag  
 Fin de carrera

A mm	I mm	Codice N°	P g	 n°
60	36	005 001 035	80	20

### Rotella a sfere

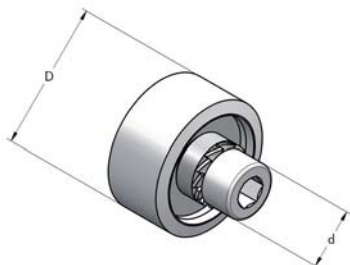

Ball bearing wheel  
 Galet aux billes  
 Kugelrädchen  
 Ruedecilla con bolas

D mm	d mm	Codice N°	P g	 n°
24	6	005 001 043	22	20

### Valvola a sfera

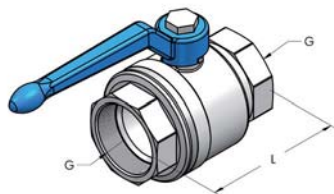

Ball valve  
 Clapet à bille  
 Kugelventil  
 Válvula esférica

G BSP	L mm	Codice N°	P g	 n°
1/2"	50	434 021 050	170	10
3/4"	68	434 026 070	300	10
1"	80	434 033 080	420	10
1"1/4	90	434 042 080	710	10
1"1/2	100	434 048 100	990	10
2"	115	434 060 120	1600	10
2"1/2	150	434 075 150	3550	10

### Valvola a sfera M/F

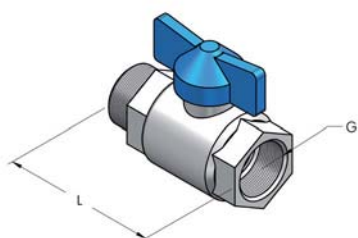

M/F ball valve  
 Clapet à bille M/F  
 Kugelventil I/A  
 Válvula esférica M/F

G BSP	L mm	Codice N°	P g	 n°
3/8"	55	434 010 055	150	10
1/2"	67	434 021 067	210	10